



Humberland Cheeseman's Green Lane

Ashford, TN25 7HX

Price £700,000

A stunning detached family home offered for sale with non onward chain.

The spacious accommodation includes a large kitchen & breakfast room, utility, cloakroom, family room, sitting & dining rooms. To the first floor, bedroom one benefits from a large walk in wardrobe and en suite in addition you will find four further bedrooms and family bathroom.

The rear garden enjoys an open outlook on to fields whilst to the front, a five bar gate provides access to the shingle driveway and integral garage. Double glazing and oil fired central heating are installed along with electric car charging point.

Viewing

Please contact our Ashford Office on 01233 646411 if you wish to arrange a viewing appointment for this property or require further information.

- IMPRESSIVE DETACHED FAMILY HOME
- FIVE BEDROOMS
- EN SUITE & WALK IN WARDROBE
- 21FT KITCHEN & 17FT BREAKFAST ROOM
- SITTING ROOM, FAMILY ROOM, DINING ROOM
- CLOAKROOM & UTILITY
- GARAGE & DRIVEWAY
- NO ONWARD CHAIN
- APPROX 1582 SAQFT
- EV CHARGING POINT



5



2



4



D

Floor Plan

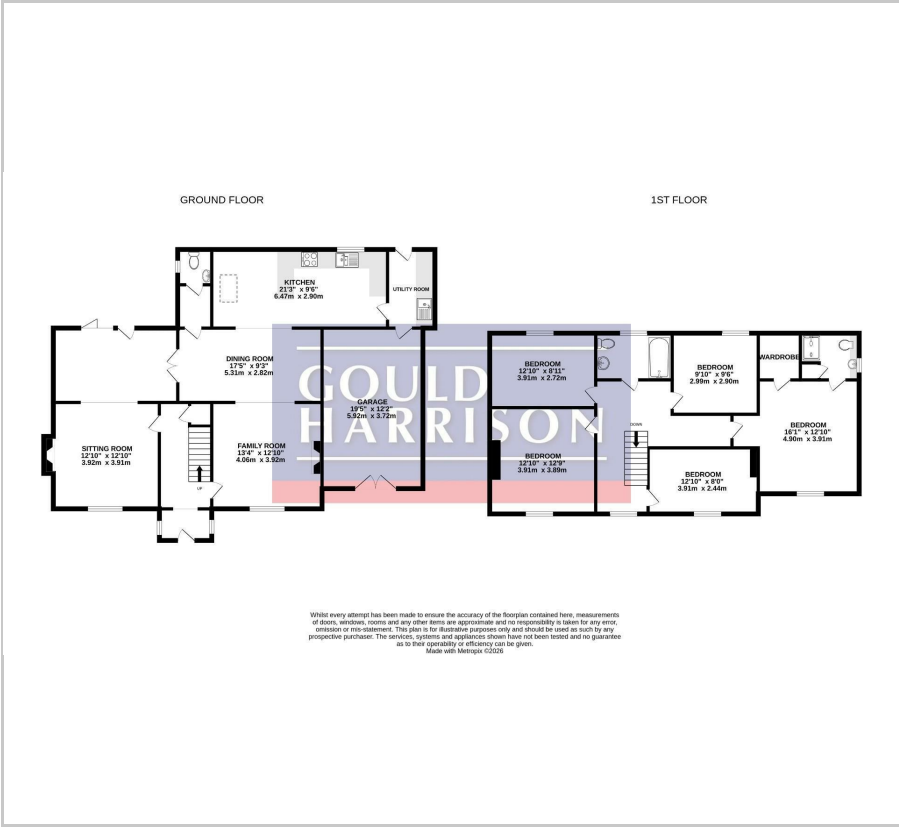

Area Map



Energy Efficiency Graph

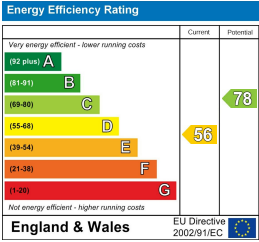

These particulars, whilst believed to be accurate are set out as a general outline only for guidance and do not constitute any part of an offer or contract. Intending purchasers should not rely on them as statements of representation of fact, but must satisfy themselves by inspection or otherwise as to their accuracy. No person in this firms employment has the authority to make or give any representation or warranty in respect of the property.